

- GENERAL NOTE(S):
- DURING CONSTRUCTION, PROVIDE TEMPORARY PROTECTIVE FENCE AROUND CLEANOUT PER 324.
 - SOLVENT WELD ALL PVC FITTINGS.
 - DURING DESIGN AND CONSTRUCTION, REVIEW LATERAL LOCATION RELATIVE TO PROPOSED DRIVEWAY. STRONG CITY OF ALACHUA PREFERENCE IS FOR CLEAN-OUT NOT TO BE INSTALLED IN DRIVEWAY. SEE CITY OF ALACHUA DESIGN AND CONSTRUCTION MANUAL.
- KEYED NOTE(S):
- CONTRACTOR SHALL VERIFY SUFFICIENT VERTICAL DIMENSION TO INSTALL UTILITIES ABOVE LATERAL.
 - DO NOT CONNECT HOUSE PLUMBING TO STUB RISER.
 - DETAIL SHOWS CLEAN-OUT (CO) IN MIDDLE OF PUE, A STRONG CITY PREFERENCE. CITY MUST APPROVE ALL OTHER CLEANOUT LOCATIONS.
 - TEMPO OMNI MARKER II: ELECTRONIC MARKER, SANITARY GREEN, MODEL OM-6, PART 52085009.

200 WASTEWATER SERVICE LATERAL
NTS

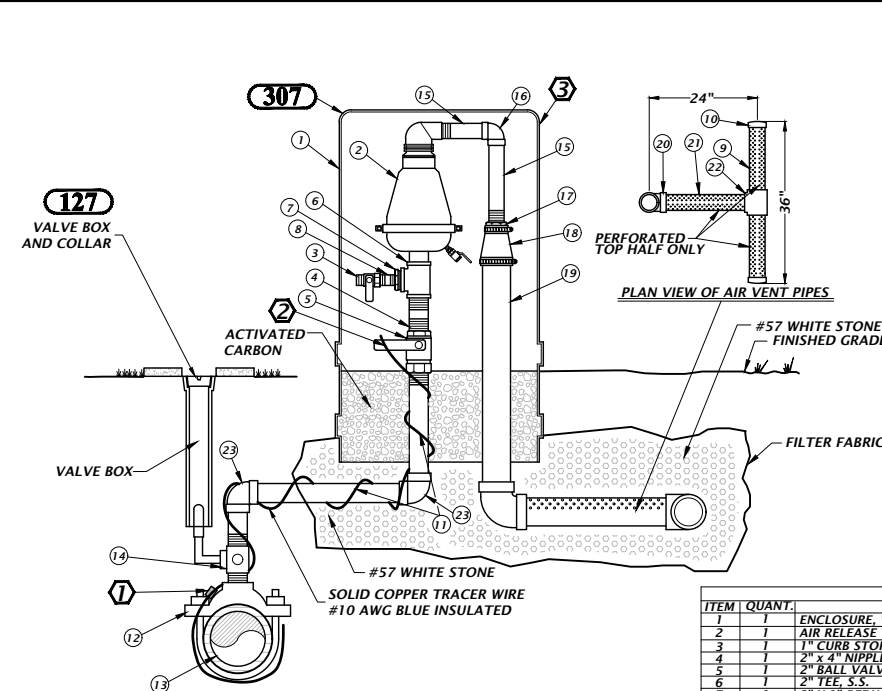

- GENERAL NOTE(S):
- AIR RELEASE VALVES 2" IN DIAMETER SHALL BE USED ON 4" THROUGH 12" DIAMETER FORCE MAINS. FOR 16" FORCE MAIN, PROVIDE TWO ARVS EACH 2" IN DIAMETER.
 - WASTEWATER AIR RELEASE VALVES SHALL HAVE ODOR PROTECTION AS SHOWN WHEN LOCATED ADJACENT TO RESIDENTIAL OR POPULATED AREAS.
- KEYED NOTE(S):
- CONNECT TRACER WIRES FROM MAIN TO ARV WITH PRO-LINE TRACER-LOCK CONNECTORS. PART # TL-LUG-SS.
 - EXTEND TRACER WIRE AT LEAST 8-INCHES ABOVE GRADE
 - ENCLOSURE SHALL BE COLOR CODED GREEN.

ITEM	QUANT.	DESCRIPTION	MATERIALS
1	1	ENCLOSURE, WATER PLUS CORPORATION MODEL #131632	
2	1	AIR RELEASE VALVE 2" NPT, ARI MODEL D-025 FOR WASTEWATER, VENT-O-MAT 050RG1162156	
3	1	1" CURB STOP, S.S.	
4	1	2" x 4" NIPPLE, S.S.	
5	1	2" BALL VALVE, SST (WITH SST HANDLE AND SST NUTS)	
6	1	2" TEE, S.S.	
7	1	2" x 1" REDUCER, S.S.	
8	1	1" SHORT NIPPLE, S.S.	
9	2	3" PIPE, PVC, LENGTH AS SHOWN, PERFORATED TOP HALF ONLY	
10	2	3" CAP, PVC	
11	1	2" PIPE, S.S., LENGTH AS REQUIRED	
12	1	2" DOUBLE STRAP TAPPING SADDLE, STAINLESS STEEL	
13	1	4" & LARGER PIPE, D.I. OR PVC (DR-18)	
14	1	MODEL 4001 S.S. FLANGED END BALL VALVE, 2" NUT WITH RIGHT ANGLE	
15	2	1-1/2" PIPE, PVC, LENGTH AS REQUIRED	
16	1	1-1/2" x 90° ELBOW, PVC	
17	1	2" x 1-1/2" REDUCER, PVC	
18	1	3" x 2" FLEX COUPLING	
19	1	3" PIPE, PVC, LENGTH AS REQUIRED	
20	1	3" x 90° ELBOW, PVC	
21	1	3" PIPE, PVC, LENGTH AS SHOWN, PERFORATED TOP HALF ONLY	
22	1	3" TEE, PVC	
23	2	2" ELBOW, SST	

203 WASTE WATER FORCE MAIN AIR RELEASE VALVE
NTS

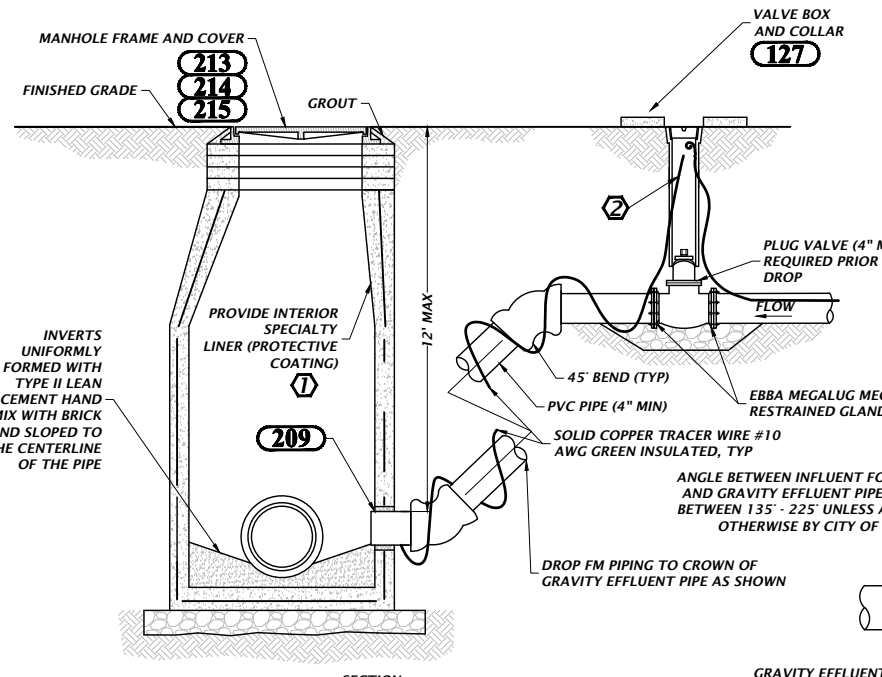

- KEYED NOTE(S):
- FOR NEW MANHOLES, PROVIDE AGRU SURE-GRIP YELLOW 3.0 MM THICK LINER. FOR EXISTING MANHOLES, PROVIDE RAVEN 405 EPOXY COATING. FURNISH AND INSTALL THESE PRODUCTS AS PER LATEST VERSION OF CITY OF ALACHUA, PUBLIC SERVICES, REQUIREMENTS FOR DESIGN AND CONSTRUCTION.
 - VALVE BOX MAY SERVE AS ACCESS POINT FOR TRACER WIRES. PROVIDE ENOUGH LOOPED TRACER WIRE SO IT CAN EXTEND AT LEAST 8-INCHES ABOVE GRADE.

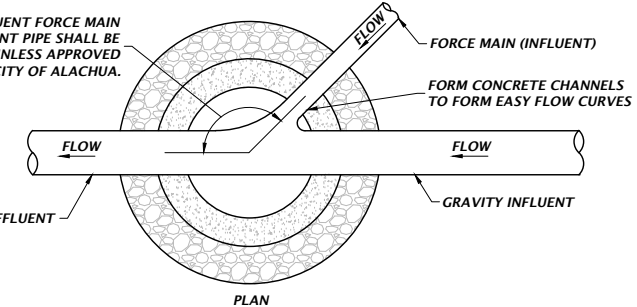

206 MANHOLE FORCE MAIN CONNECTION
NTS

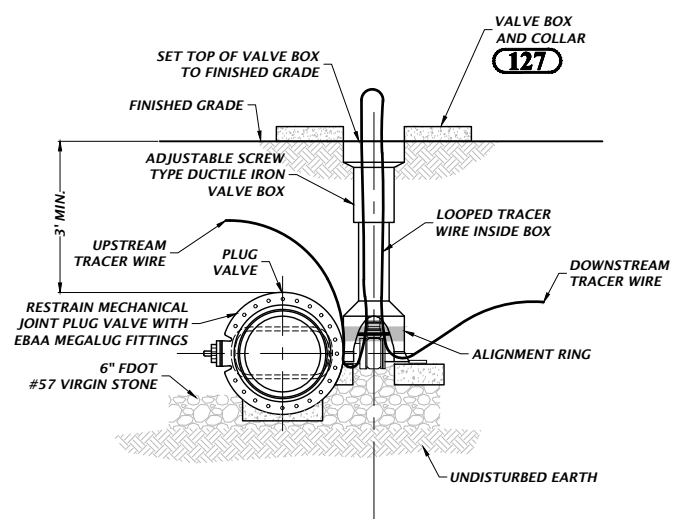

- GENERAL NOTES:
- THE VALVE ACTUATING NUT SHALL BE EXTENDED UP TO BE WITHIN 3" OF FINISHED GRADE.
 - PROVIDE A PLASTIC DEBRIS SHIELD / ALIGNMENT RING THAT INSTALLS BELOW THE VALVE ACTUATING NUT. THIS SHIELD SHALL CENTER THE RISER PIPE BOX OVER THE ACTUATING NUT AND MINIMIZE INFILTRATION.
 - FOR NEW CONSTRUCTION, THE VALVE BOX SHALL BE ADJUSTED TO MIDRANGE TO ALLOW FOR FUTURE BOX ADJUSTMENTS.
 - VALVE BOX SHALL BE SET ON SOLID COMMON BLOCKS.
 - PVC EXTENSION SHALL NOT BE USED ON VALVE BOX INSTALLED.
 - LETTER VALVE BOX LID WITH "WW FORCE MAIN"
 - VALVE BOX MAY SERVE AS ACCESS POINT FOR TRACER WIRES. PROVIDE ENOUGH LOOPED TRACER WIRE SO IT CAN EXTEND 8 INCHES ABOVE GRADE.

207 PLUG VALVE FOR WASTEWATER FORCE MAIN 4" OF LARGER
NTS

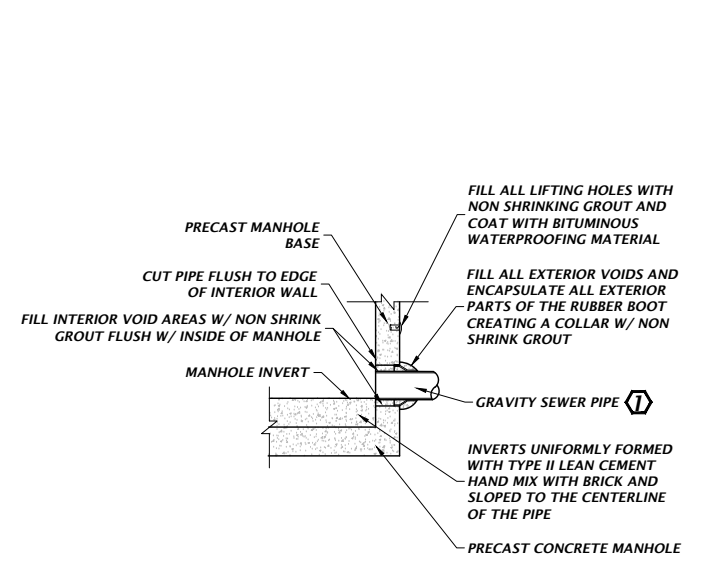

- GENERAL NOTE:
- RUBBER BOOT, DOUBLE BANDED, 316 S/S CLAMPS, MEETING THE ASTM C923 STANDARD. Kor-N-Seal® I EX SERIES CONNECTOR WITH DOUBLE STAINLESS STEEL BANDS OR EQUAL
- KEYED NOTE(S):
- ESPECIALLY FOR RETRO FIT WORK, INSTALLING A GRAVITY SEWER PIPE UP TO 2 FEET ABOVE INVERT IS PERMISSIBLE.

209 MANHOLE PIPE CONNECTION
NTS

02A WASTEWATER DETAILS - SEE (151) FOR ABBREVIATIONS - REVISION 1 3/3/2020 & 4/20/2020