

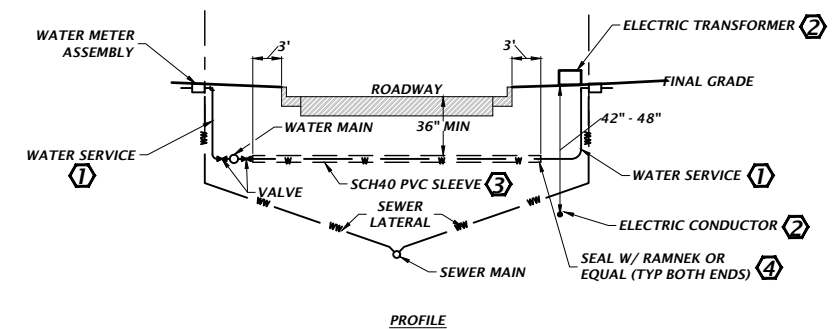

KEYED NOTE(S):

- ① WATER METER SERVICE SHALL BE 2" PVC, OATEY PRIMER AND SOLVENT WELD JOINTS. LOCATE TO AVOID CONFLICT WITH LOCATIONS OF ELECTRIC TRANSFORMERS AND FIRE HYDRANTS.
- ② ELECTRIC CONDUCTORS MAY BE ON EITHER SIDE OF THE ROADWAY. WATERMAIN SHOULD BE ON THE OPPOSITE SIDE OF TRANSFORMERS.
- ③ PVC SLEEVE TO BE 4" BLUE SCHEDULE 40 PVC SOLVENT WELD.
- ④ SEAL BOTH ENDS OF 4" SLEEVE WITH RAMNEK OR EQUAL.
- ⑤ MARK LOCATION OF SLEEVE CROSSING WITH "X" ON BACK OF CURB. (421)

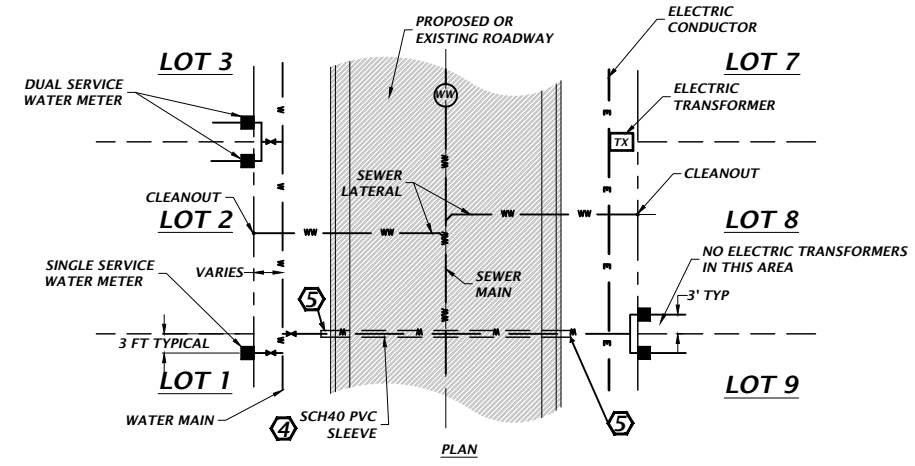

312 SUBDIVISION SERVICE CONNECTIONS & 2-INCH WATER SERVICE UNDER ROADWAY
NTS

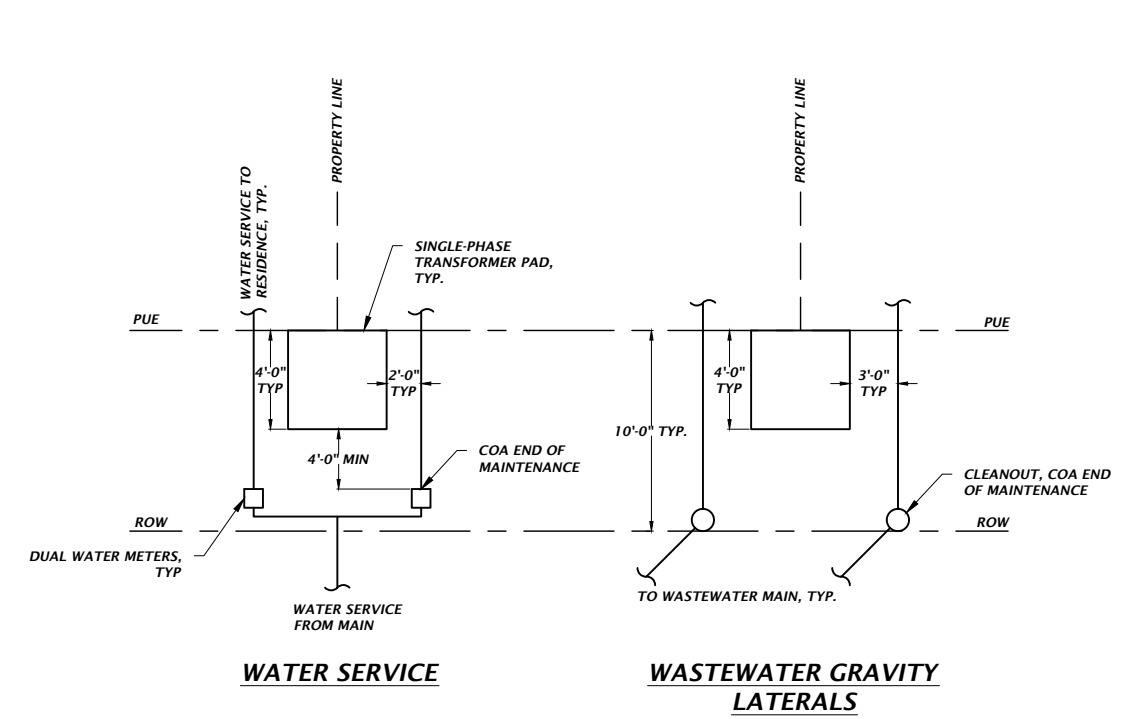

327 TYPICAL ROUTING OF WATER AND GRAVITY WASTEWATER PIPING NEAR TRANSFORMERS
NTS

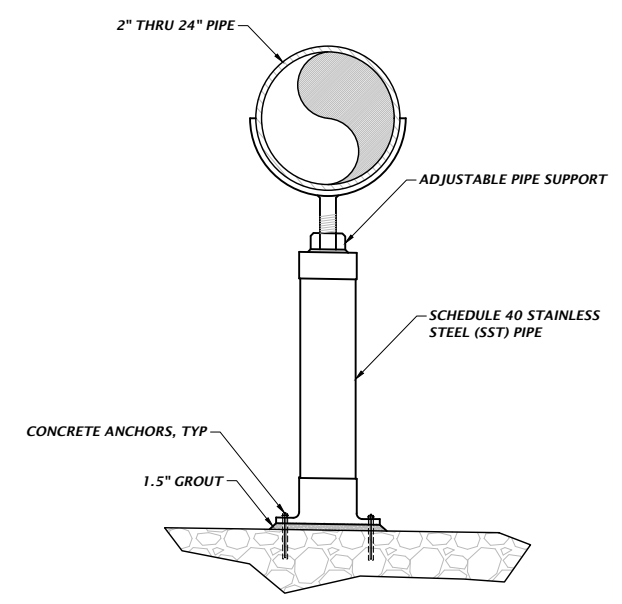

GENERAL NOTE(S):

- 1. ALL PIPE SUPPORT PARTS SHALL BE 304L SST.
- 2. MANUFACTURER AND PRODUCT:
 - STANDON PIPE SUPPORTS, FOREST GROVE, OREGON OR EQUAL
 - MODEL S92

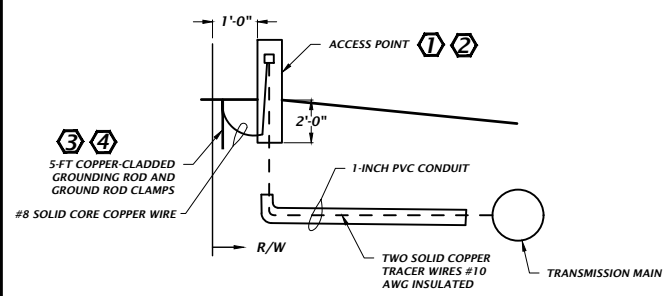

GENERAL NOTE(S):

- 1. THIS DETAIL APPLIES TO WATER, WASTEWATER, OR RECLAIMED WATER TRANSMISSION MAINS.

KEYED NOTE(S):

- ① PRODUCT: PROMARK CATHODIC PROTECTION TEST-STATION, 3-INCH TEST STATION WITH STANDARD 5 STAINLESS STEEL TERMINALS, PART # PM-TS3.
- ② COLORS: BLUE FOR POTABLE WATER, GREEN FOR WASTEWATER, PURPLE FOR RECLAIMED WATER.
- ③ INSTALL ROD SO TOP IS ABOUT 3-INCHES BELOW GRADE.
- ④ DO NOT LOCATE GROUNDING ROD IN PATH OF TRACER WIRE.

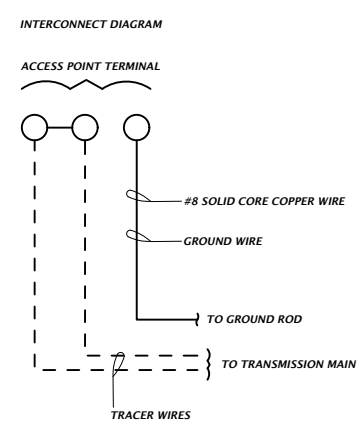

318 ACCESS POINT FOR TRANSMISSION MAIN
NTS

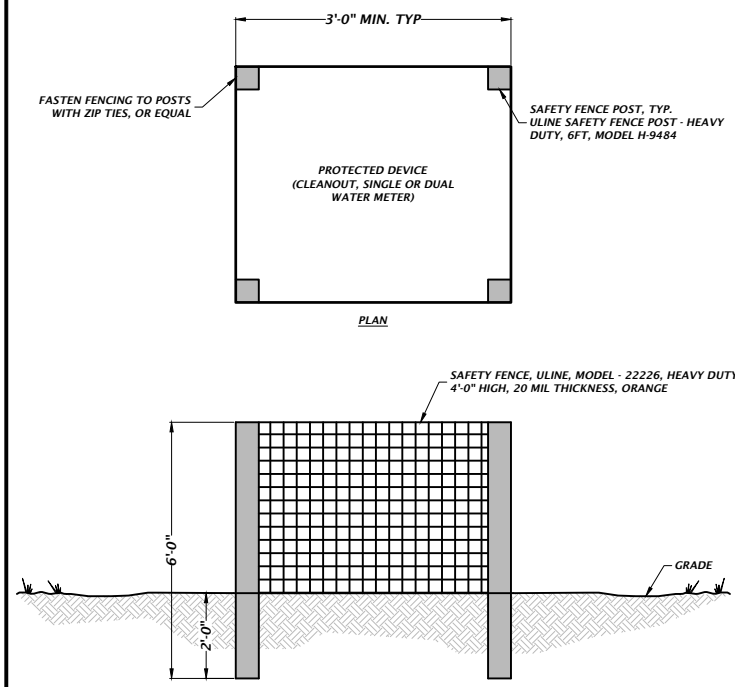

GENERAL NOTE(S):

- A. PROVIDE TEMPORARY PROTECTIVE FENCE AS SOON AS DEVICE (CLEANOUT, WATER METER BOX AND/OR YOKE BAR) IS INSTALLED.
- B. REMOVE FENCE ONCE BLDG HAS RECEIVED CERTIFICATE OF OCCUPANCY (CO).

324 TEMPORARY PROTECTIVE FENCE
NTS

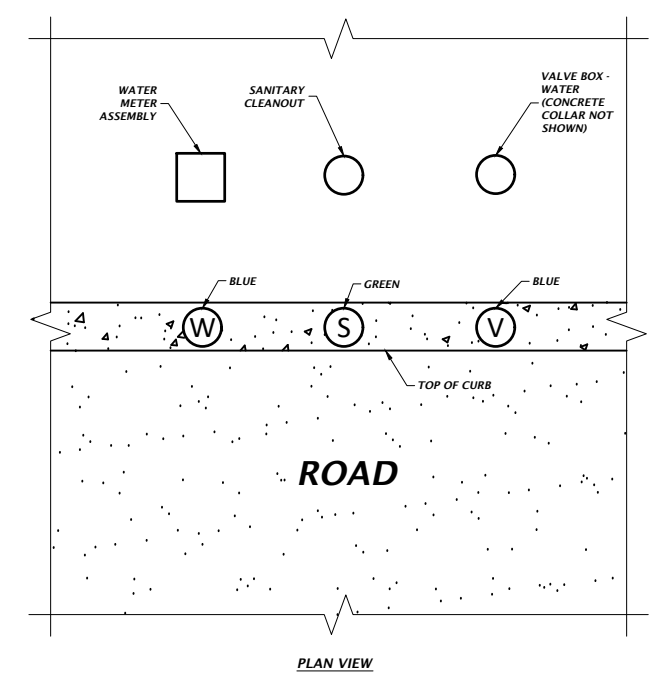

GENERAL NOTES:

- 1. COORDINATE WITH COA STAFF.
- 2. INSCRIBE "W", "S", OR "V", AS APPLICABLE.
- 3. SPRAY, PAINT (307) OVER AND AROUND INSCRIPTION. COLOR AS SHOWN.

330 CURB MARKINGS FOR WATER METERS, SANITARY CLEANOUTS, AND WATER VALVES
NTS

312

327

315

324

330

03B WATER AND WASTEWATER DETAILS - SEE (151) FOR ABBREVIATIONS